



THE DIPSTICK

JANUARY 1981

PRESIDENT: Jim Banvard (340-6737)
VICE PRES: Ross Haines (486-1496)
SECRETARY: Andy Wallach (583-9387)
TREASURER: Sandy Hall (482-2821)
EDITOR: Carol Wallach (583-9387)

Greetings all--

The new year is upon us and with it comes a change in the editorship of this newsletter. I would like to thank Susan Boswell for the excellent job she did as editor for the past several years. I'll admit to having been somewhat hesitant to try to take her place, but the sight of our noble president on his knees before me was more than I could bear and I relinquished. All contributions and suggestions that any of you can give me will be greatly appreciated.

FROM OLDE NUMBER 6900--

In view of the fact that old no. 2400, 7085, 4270 and VM199 has to do some more reserve work today and there are two football games today and yesterday was spent dismantling our newest half acquisition and this is the season of doing for others, I am writing a few words. January 17 will be the Fifth Annual Wicker Basket Affair. If Mother Nature is kind, some of us can overflow onto our new deck. Unfortunately, it will probably snow.

A new year--time for resolutions: "I will rub out the TD this year." "I will rebuild the brake master cylinder this year." "I will put my TF on the road this year." etc., etc. Maybe, with two GOF's coming up, some of the resolutions will be kept.

I was called out in that yucky rain Saturday to help push this monstrosity up our driveway into the garage. When it would hardly budge with Roosevelt, Hank, Jim, Michael Banvard and me pushing, Jim and Hank bowed to the obstinacy of the left front brake and pulled off the drum. Then it was easy. I found out later that Jim had had to ride in the car to steer it home because of that left front brake. Oh, by the way, Jim is part owner with Hank on a '38 VA Tourer-- hopefully to help the VA owners in our club get some needed parts.

Hope your Christmases were super! Probably several of you opened small boxes to find lists of parts that will soon arrive, as Jim did. Maybe others of you had gift-givers who planned more in advance than I and so got real parts. Oh well.

Hope Susie and Dan had success this weekend in house hunting. If I don't see you Jan. 6, Jim will. And I hope to see you Jan. 17 at 7:00. Once again we'll have Sangria, beer, lemonade, and coffee. If anyone prefers something else, feel free to bring it.

Brenda

FROM OLDE NUMBER 2400, etc.--

Let's see a good turn out on Tuesday the sixth. This will be primarily a planning meeting for the year to come so be with us with your ideas and contributions. The driving season isn't really that far down the pike. Happy New Year; I feel the old one has been good to us even with the official demise of .MG.

Jim

THE CHRISTMAS PARTY

as reported by Andy Wallach

About forty members and guests once again enjoyed the generous hospitality of Helen and Dave Barrows in their gracious home for our Christmas Party/December meeting. While not attempting to make these minutes complete by conjuring up the myriad delicacies served or reporting the somewhat liquor-laced communications, several points will be mentioned. Mary Thompson and all other members were able to identify themselves with their individual marque. Bob Salvin's and Robert Davis's little black books must have run dry--both were sans date. Carl Fisher was noted instructing Roy Wiley in the proper method of tying a tie--everyone agreed it's a good thing that Carl only has daughters. Roy and his date created quite a stir--until someone pointed out that she was his daughter. Hank Giffin managed to hold onto his pea all night. There was some MG talk. Bess and Pat Mann were heard discussing the good features of operating MGAs, and the reemergence of the "Pink TD" was a topic of much conversation. Many thanks to Helen and Dave for another great party.

UPCOMING EVENTS

The January Meeting will be held on Tuesday, January 6 at the home of Walt and Mary Thompson.

Wicker Basket Affair--Saturday, January 17, 7 P.M. at the Banvard's. For the benefit of the uninitiated, this is our annual pot luck and is always a marvelous feast. Please call Brenda (340-6737) at least a week in advance to let her know what you'll be bringing--hors d'oeuvre, meat, vegetable, dessert.

5th Annual
Wicker Basket Affair

Jim & Brenda Banvard
3633 Van Buren Dr.
Va. Beach 340-6737

Sat, Jan. 17, 7 P.M.

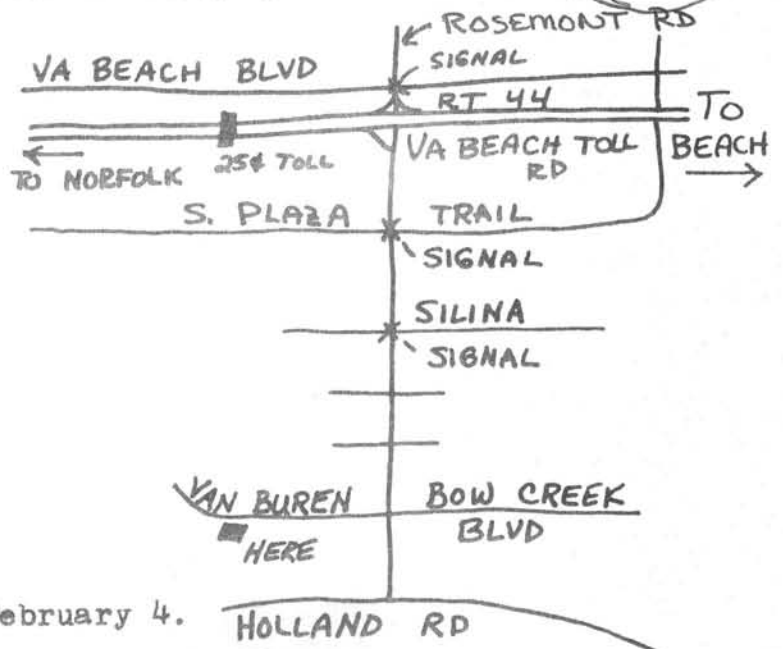

February Meeting--Wednesday, February 4.

Tech Session--Sunday, February 15, 10 A.M.

DEADLINE FOR THE FEBRUARY NEWSLETTER IS JANUARY 25.

(The following is an excerpt from an article in MG TALK, the newsletter of the Southeastern MG F Register, Ltd.)

Murphy's Law as Applied to "Ts" in General:

- If there is a possibility of several things going wrong, the one that will cause the most damage will be the one to go wrong.
- Everything the British put together falls apart sooner or later.
- When any mechanical contrivance fails, it will do so at the most inconvenient time.
- The reliability of any "T" at a GOF is inversely proportional to the number of persons watching it.

Murphy's Law as Applied to "T" Parts:

- Interchangable parts won't.
- Parts for the XPAG engine that positively cannot be assembled in improper order will be.
- Any "T" part requiring service or adjustment will be least accessible.
- If the restoration requires "x" components, Moss will have "x" minus one in stock.
- Firmness of Moss' delivery dates is inversely proportional to the tightness of the restoration schedule.
- After adding two weeks to the Moss delivery schedule for unexpected delays, add two more for the unexpected, unexpected delays.

Murphy's Law as Applied to the Workshop Manual:

- When all else fails, read the instructions.
- If you do not understand a particular word or phrase in the workshop manual, ignore it. The manual will make perfect sense without it.
- The most vital instruction in the workshop manual stands the greatest chance of being obliterated by grease.

Murphy's Law as Applied to Workshops and Workbenches:

- After the transmission has been assembled, extra components will be found on the bench.
- An object will fall from the bench so as to do the most damage.
- The most delicate component will be the one to fall.
- "T" parts, when dropped, will roll into the least accessible corner of the workshop.
- The accessibility during recovery of "T" parts which fall from the work bench varies directly with the size of the part and inversely with its importance to the completion of work underway.

Murphy's Law as Applied to General Repairs:

- When an adjustment error has been detected and corrected, it will be found to have been correct in the first place.
- After the adjustment correction has been found in error, it will be impossible to adjust back to the original setting.
- After the last of 16 mounting screws has been removed from an access cover, it will be discovered that the wrong access cover has been removed.
- After an access cover has been secured by the last of 16 screws, it will be discovered that the gasket has been omitted.
- Anything can be made to work if you fiddle with it long enough.
- If it jams--force it. If it breaks, it needed replacing anyway.

COME JOIN US AT THE WICKER BASKET AFFAIR
DON'T FORGET TO CALL BRENDA AND TELL HER WHAT YOU'LL BE BRINGING

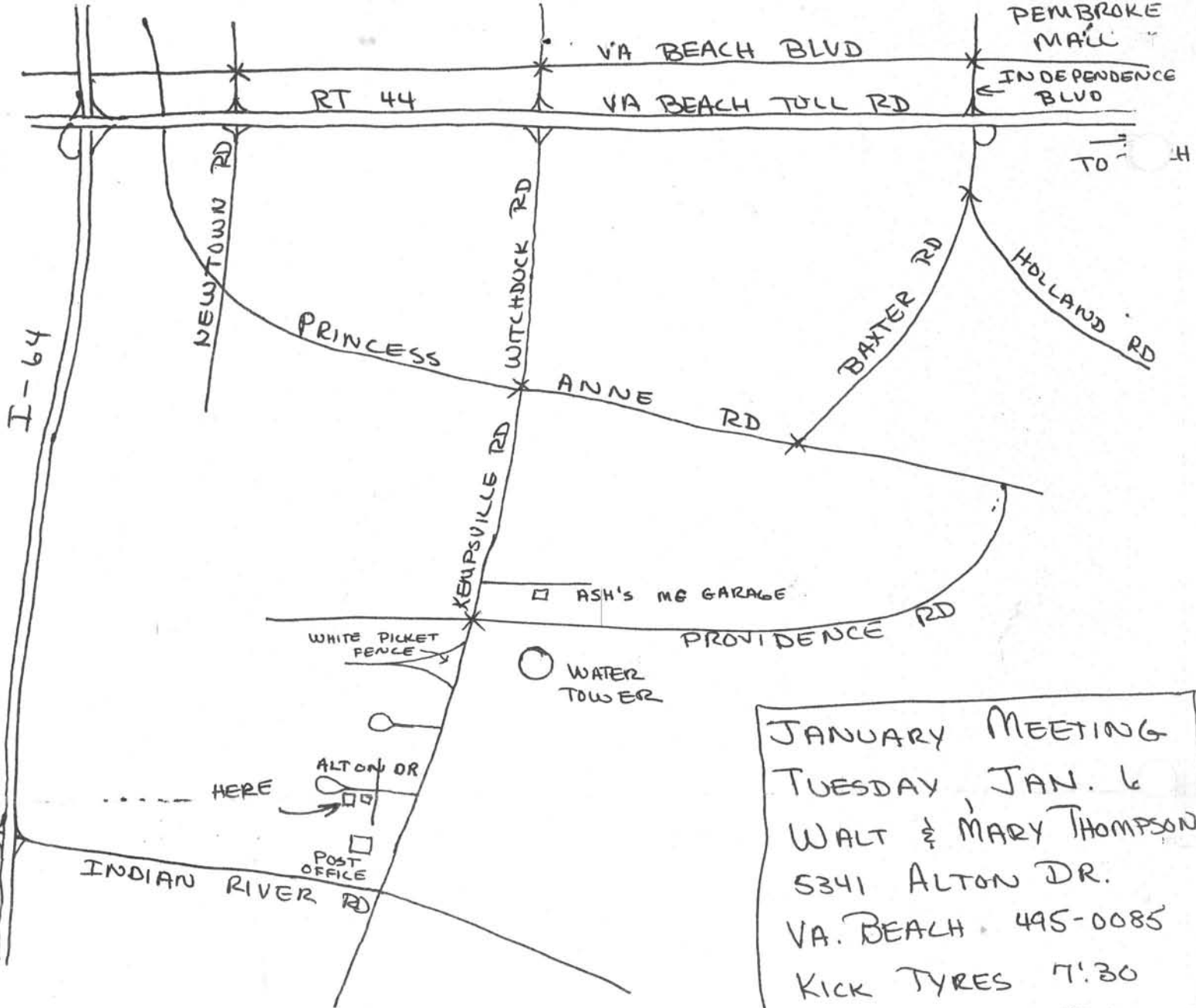

JANUARY MEETING
 TUESDAY, JAN. 6
 WALT & MARY THOMPSON
 5341 ALTON DR.
 VA. BEACH. 495-0085
 KICK TYRES 7:30
 MEETING 8:00

TIDEWATER MG 'T' CLASSICS
 7704 BERGEN ST.
 NORFOLK, VA. 23518



ROSS & ANN HAINES
 633 PINE TREE DR
 VA BEACH VA 23452